

INSTRUCTIONS





CAUTION:

If the flexible wire or cord of this light is damaged, it should substitute its technic service exclusively or a person of equivalent qualifications with the object of avoid any risk".

PARAMETERS:

Model No.	Rated wattage	Rated voltage	Frequency	Input current	PF
DLSU6-MCT5	14.8W	120V	60Hz	140mA	0.7

SUITABLE J-BOX INSTALLATION

	3-1/2" and 4" Octagon Box Steel	3-1/2" and 4" Drawn Round Ceiling Pan	3-1/2" and 4" Plastic box
Mounting Hole Distance	2.75"/3.5"	2.75"/3.5"	2.75"/3.5"
Picture			

INSTALLATION:

STEP1.

Disconnect power before servicing. Remove the existing bulb or remove the existing trim if necessary.

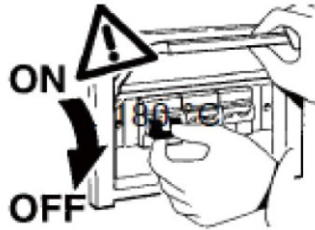

STEP2.

As shown in figure 1 Hold the lens down and turn it counterclockwise to remove the lens.

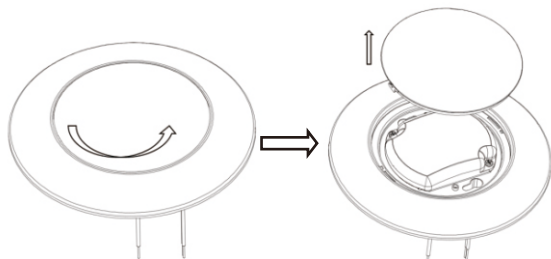

Figure 1

STEP3.

As shown in figure 2 Connect black and white wire and ground wire with connector respectively. As shown in Figure 2A. Adjust the CCT switch according to the environment, if it is 5CCT version.

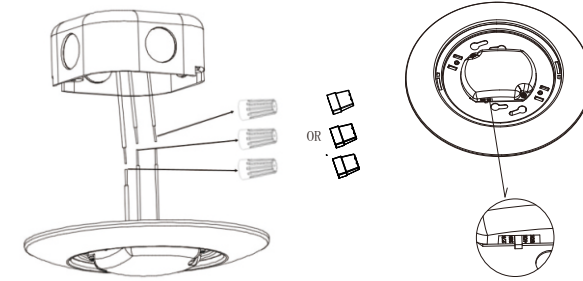

Figure 2

Figure 2A

STEP4.

As shown in figure 3 After fully placing the black and white wire and ground wire into the j-box, lock the lamp on the j-box with two 8#-32 screws.

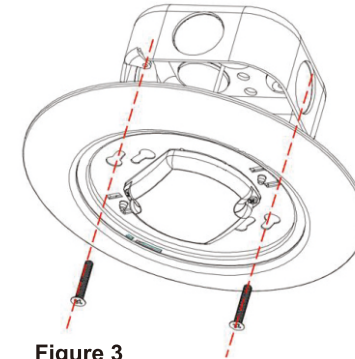

Figure 3

STEP5.

As shown in figure 4 Rotate the lens into the lamp again (the two buttons on the lens should be aligned with the two slots on the lamp , and then tighten it clockwise).

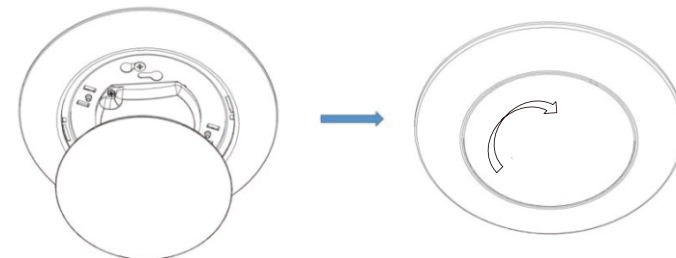

Figure 4

STEP6.

Check to see if the product's exterior surface is installed on the ceiling so that there is no gap between them.

STEP7.

Turn the power switch back on to verify that the product is working properly.

SUITABLE 5"/6" HOUSING INSTALLATION

- Shrapnel install as shown (figure1, figure3, figure4, figure6)
- Spring install as shown (figure2, figure3, figure5, figure6)

STEP1.

Disconnect power before servicing. Remove the existing bulb or remove the existing trim if necessary.

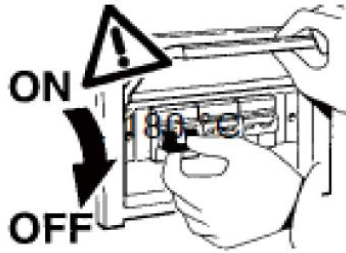

STEP2-A.

As shown in figure 1
Install the lamp body with 2pcs metal shrapnel set

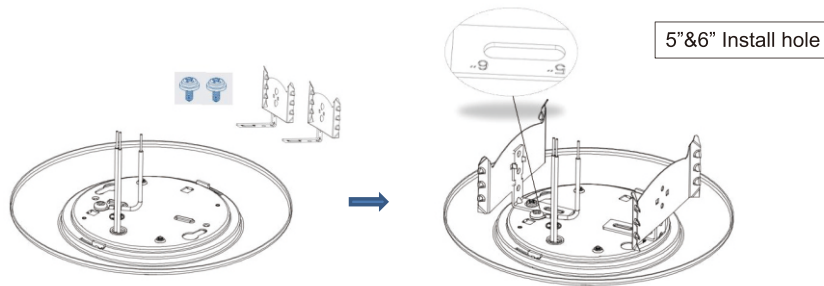

Figure 1

STEP2-B.

As shown in figure 2
Install the lamp body with 2pcs Spring assembly

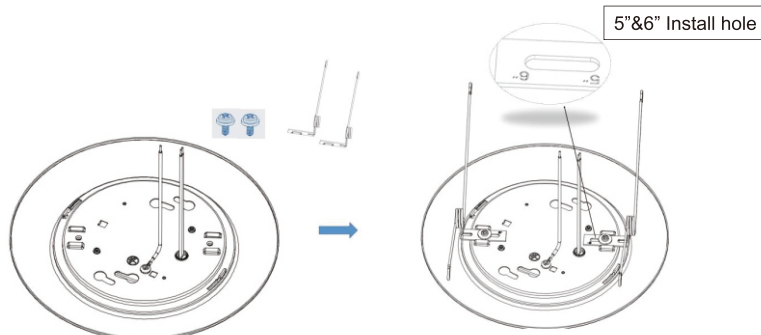

Figure 2

STEP3.

As shown in figure 3

Screw E26 Edison base Lampholder Fitting or GU24 base Lampholder Fitting into existing base socket in housing.

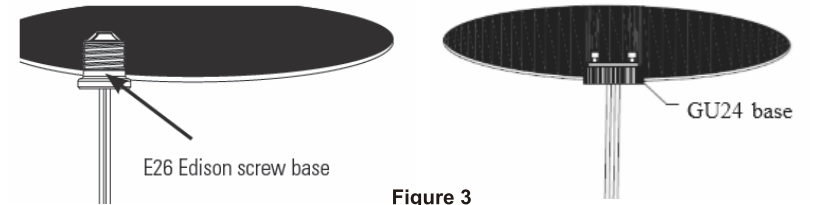

Figure 3

STEP4-A.

As shown in figure 4

Screw E26 Edison base Lampholder Fitting or GU24 base Lampholder Fitting into existing base socket in housing.

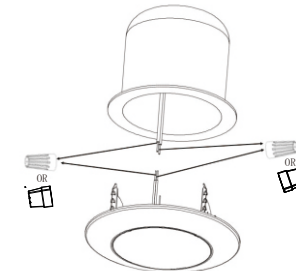

Figure 4

STEP4-B.

As shown in figure 5

Arranging the ends of spring inside the lamp holder bayonet (as shown in Figure 4), and then push the LED retrofit kit into the recessed light fixture until its outer edge is flush against the ceiling surface.

As shown in Figure 5A. Adjust the 5CCT switch according to the environment, if it is 5CCT version.

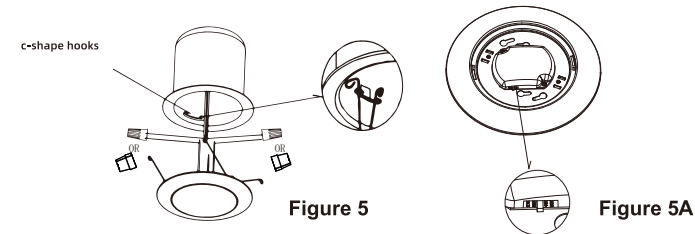

Figure 5

Figure 5A

STEP5.

As shown in figure 6

Turn on the power supply.



Figure 6

WARNING OF MAINTENANCE:

- Turn off power before Maintenance.
- If the Driver have been secured on ceiling via key holes by screws, please Access above ceiling to unscrew the driver for field inspection of supply connection.